

API 6D Trunnion Ball Valves



Welded Body Trunnion Ball Valve



Three Piece Body Trunnion Ball Valve

Company Profile

Headquartered in Houston, Texas, USA, VOLK Flow Controls, Inc. is a leading valve manufacturer for the Power, Oil & Gas, Refining, Petrochemical, Chemical, Mining, Metals, Pulp & Paper, and Marine industries with installations throughout the globe.

Valves such as soft seated ball valves, gate valves, globe valves, check valves, control valves, and instrument valves, together with severe service metal seated zero leakage ball valves and severe service control valves, are available in a wide range of sizes, materials, and pressure classes.

In addition to valves, VOLK Flow Controls also offers the GT (GIANT TORK) complete range of electric and pneumatic actuators suitable for linear and quarter-turn valves.

All VOLK Flow Controls products are designed, engineered and manufactured by experienced industry engineers to provide safe, reliable, dependable and affordable valves, actuators and solutions. Products are tracked in the field using our database to monitor performance and service life.

VOLK Flow Controls operates a full service valve maintenance facility with a complete scope of work that includes valve modifications (trim, end connection, cryogenic extension), testing and remanufacturing. In addition to MRO (maintenance, repair, and overhaul) services and inventory modifications for our customers, our maintenance facility serves as a complete warranty center for all VOLK Flow Controls products.

Together with continual feedback from our customers as well as our experience in manufacturing and quality control, VOLK Flow Controls aims to provide our customers the best quality products with the most competitive pricing, on-time delivery and full warranty service right here in Houston.

VOLK Flow Controls is an ISO 9001:2008 certified corporation, with additional certifications that include API 6D , API 602, API 607, and EC Certificate of Conformity. VOLK also employs NACE Certified Coating Inspectors full-time to ensure that the finished products are compliant with NACE requirements.



ISO 9001:2008 Quality Management System

VOLK Flow Controls is ISO 9001: 2008 certified for the design, production, and sales of valves and valve parts.

CERTIFICATE OF REGISTRATION



This is to certify that the
Quality Management System of:

VOLK Flow Controls, Inc.
6820 Easthaven Blvd.
Houston, TX 77017
USA

has been assessed and found complying with the requirements of

ISO 9001:2008

Approval is hereby granted for registration providing the
Certification rules and conditions are observed at all times.

Certification Scope:

Design, production and sales of valves and valve parts

Certificate Number: 1103001

Audit Date: 7-Apr-2015

Issue Date: 17-Apr-2015

Expiration Date: 16-Apr-2018

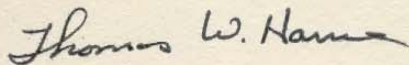

On Behalf of:
Management Certification NA



This certificate is non-transferable and remains the property of Management Certification of North America,
51 E. Crystal Canyon Circle, The Woodlands, Texas, to whom it must be returned upon request.

Reference Standards

VOLK trunnion ball valves are designed, manufactured and tested in full compliance with the following standards:

American Petroleum Institute

API 6D	Specification for Pipeline Valves
API 607	Fire Test for Soft Seated Ball Valves
API 6FA	Specification for Fire Test for Valves
API 598	Valve Inspection and Test

American Standards

ASME B1.20.1	Pipe Threads, General Purpose
ASME B16.5	Pipe Flanges and Flanged Fittings
ASME B16.10	Face-to-Face and End-to-End Dimension of Valves
ASME B16.25	Buttwelding Ends
ASME B16.34	Valve-Flanged, Threaded, and Welding End
ASME B16.47	Large Diameter Steel Flanges: NPS 26 through NPS 60 Metric/Inch Standard
ASME B31.3	Process Piping

ASME Boiler and Pressure Vessel Code (BPVC)

Section II	Materials, Part D: Properties
Section V	Nondestructive Examination
Section VIII	Rules for Construction of Pressure Vessels
Section IX	Welding and Brazing Qualifications

ISO

ISO 5208	Industrial Valves-Pressure Testing of Valves
ISO 10497	Testing of Valve-Fire type-testing requirements
ISO 15156	Petroleum and Natural Gas Industries- Materials for use in H2S-containing environments in oil and gas production

MSS SP

MSS-SP-6	Standard Finish for Contract Face of Pipe Flanges and Connecting End Flanges of Valves and Fittings
MSS-SP-25	Standard Marking System for Valves, Fittings, Flanges and Unions
MSS-SP-55	Quality Standards for Steel Castings
MSS-SP-61	Hydrostatic Testing of Steel Valves
MSS-SP-72	Ball Valves with Flanged or Buttwelding Ends for General Service
MSS-SP-82	Valve Pressure Testing Methods

NACE

NACE MR0103	Materials Resistant to Sulfide Stress Cracking in Corrosive Petroleum Refining Environments
NACE MR0175	Materials for Use in H2S-containing Environments in Oil and Gas Production



Fully-welded Body Ball Valve

VOLK's fully welded ball valve design provides the strength of forged components with durability and uniform structure that substantially reduces the risk of potential leak paths. Engineered for reliable, limited upkeep service in even the most punishing of conditions, the VOLK fully welded ball valve is well-suited to perform in a wide variety of pipeline applications.



Size	2" to 60" (DN 50 to DN 1500)
ANSI Class	150 to 2500

Bolted Body Ball Valve

VOLK's three piece, full bore body trunnion mounted ball valves are engineered for a wide scope of diameters, pressure classes, and applications. Manufactured from carbon steel, stainless steel, or exotic alloys, these forged valves provide long lasting, reliable service for even the most severe of conditions.



Size	2" to 60" (DN 50 to DN 1500)
ANSI Class	150 to 2500

Standard Design Features

■ Positive Blowout Proof Stem

Unlike some designs which use a pin through the stem to achieve blowout prevention, the VOLK design uses oversized split collars around the base of the stem, which creates a diameter larger than the stem and in turn locates within a recess in the valve body. This ensures the stem is held captive at all times within the valve body, unlike pins which have been known to shear and allow the stem to blow out of the body.

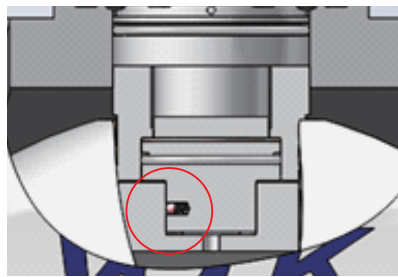
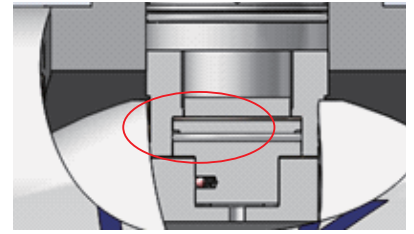

■ Anti-static Design

The spring on the stem connects the ball, stem and body, which can transfer the static electricity generated during the open-close of valves or when the fluid flows through the cavity, avoiding the aggregation of electricity.

■ Emergency Sealant Injection

Emergency sealant injection is designed on seat and stem to ensure sealing under emergency and minimize leakage.

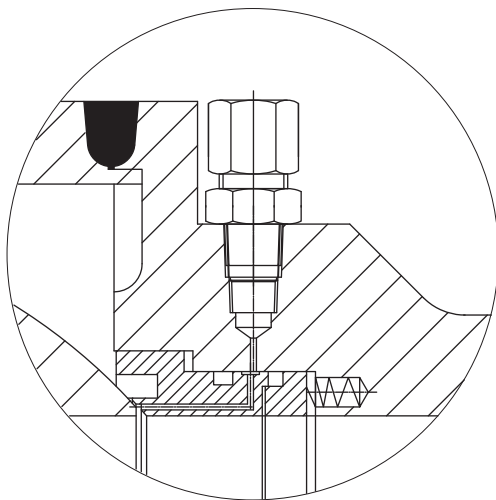

Emergency sealant injection on seat

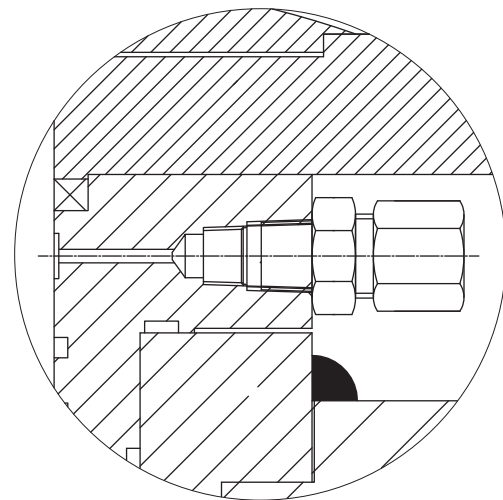

Emergency sealant injection on stem

Standard Design Features

■ Fire Safe Seat

Under fire conditions, the metal back-up seat ring seals between the seat and the ball as the soft seat melts and extrudes downstream. This provides isolation in accordance with API 607.

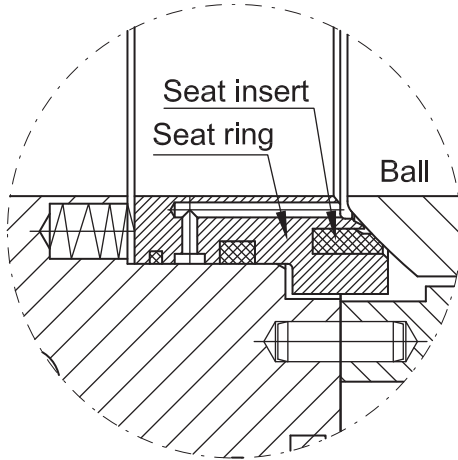

Under normal working condition

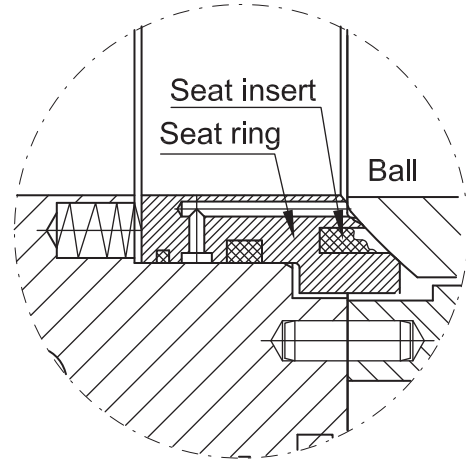

After fire

■ Double Block & Bleed

VOLK trunnion ball valves are suitable for use in block and bleed applications, where fluid in the body is evacuated through a drain port while both the upstream and downstream pressure are isolated.

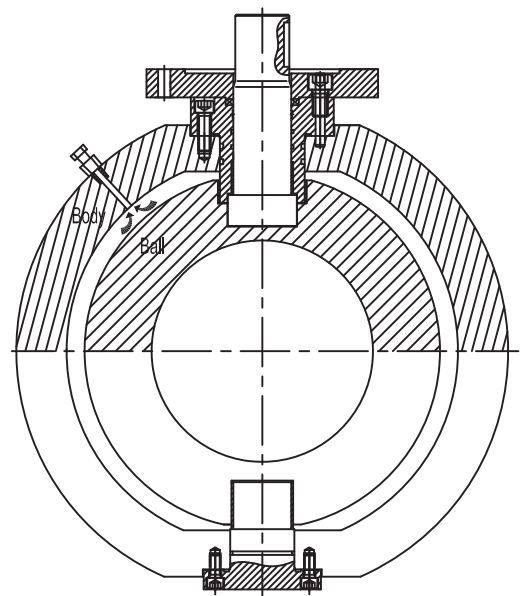
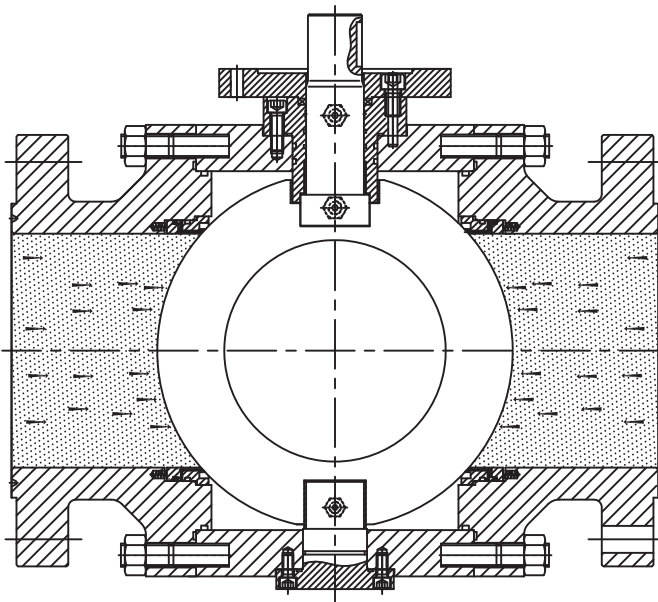

Optional Features

■ Single Piston Seat

Fluid pressure acts on the surface area of the piston in each seat pocket, resulting in the seat being pushed on to the ball. In the event the pressure in the cavity is greater than the spring force and fluid pressure, the seats are no longer loaded on to the ball. Over-pressure in the valve can be relieved in the open or closed position.

SELF RELIEVING SEATS

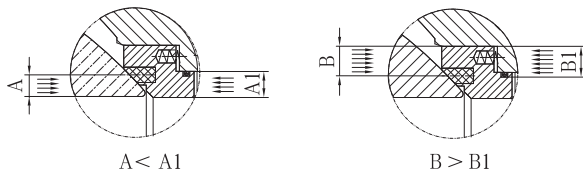

■ Double Piston Seat

The force generated by the upstream and downstream fluid pressure pushes the seat on to the ball for the seal. Double piston seals cannot self-relieve over-pressure in the cavity and a vent valve has to be installed in the cavity for this purpose.

DOUBLE PISTON EFFECT

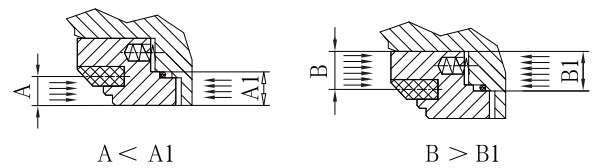

■ Extended Stem

Extended stems may be designed and installed onto fully welded ball valves that will be buried, installed underground, or in areas that are inaccessible. The extension will be manufactured in accordance with the customer's requirement.

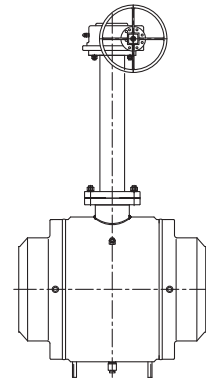

■ Transition Pup

For easier installation onto pipelines, transition pups may be welded onto VOLK trunnion ball valve ends.

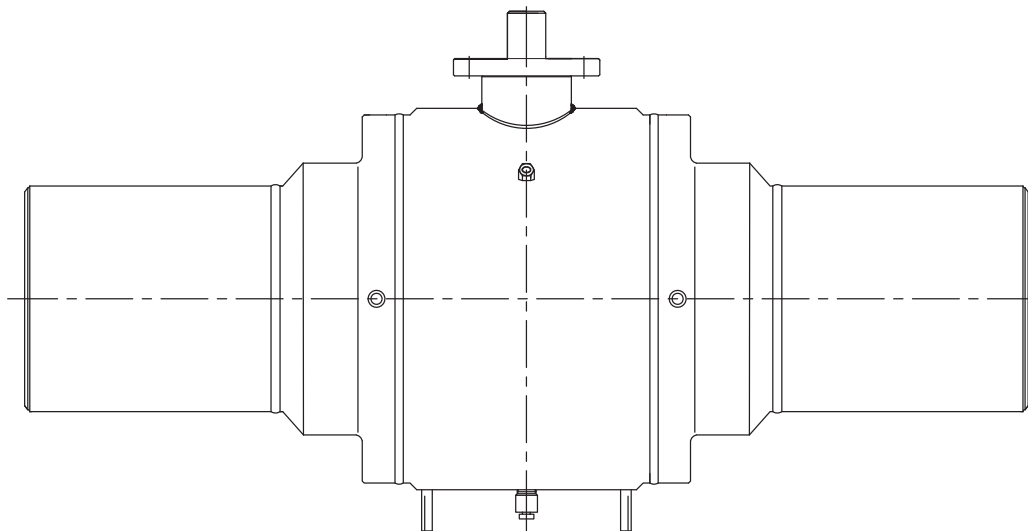

Fully-welded Body Ball Valve - Exploded View

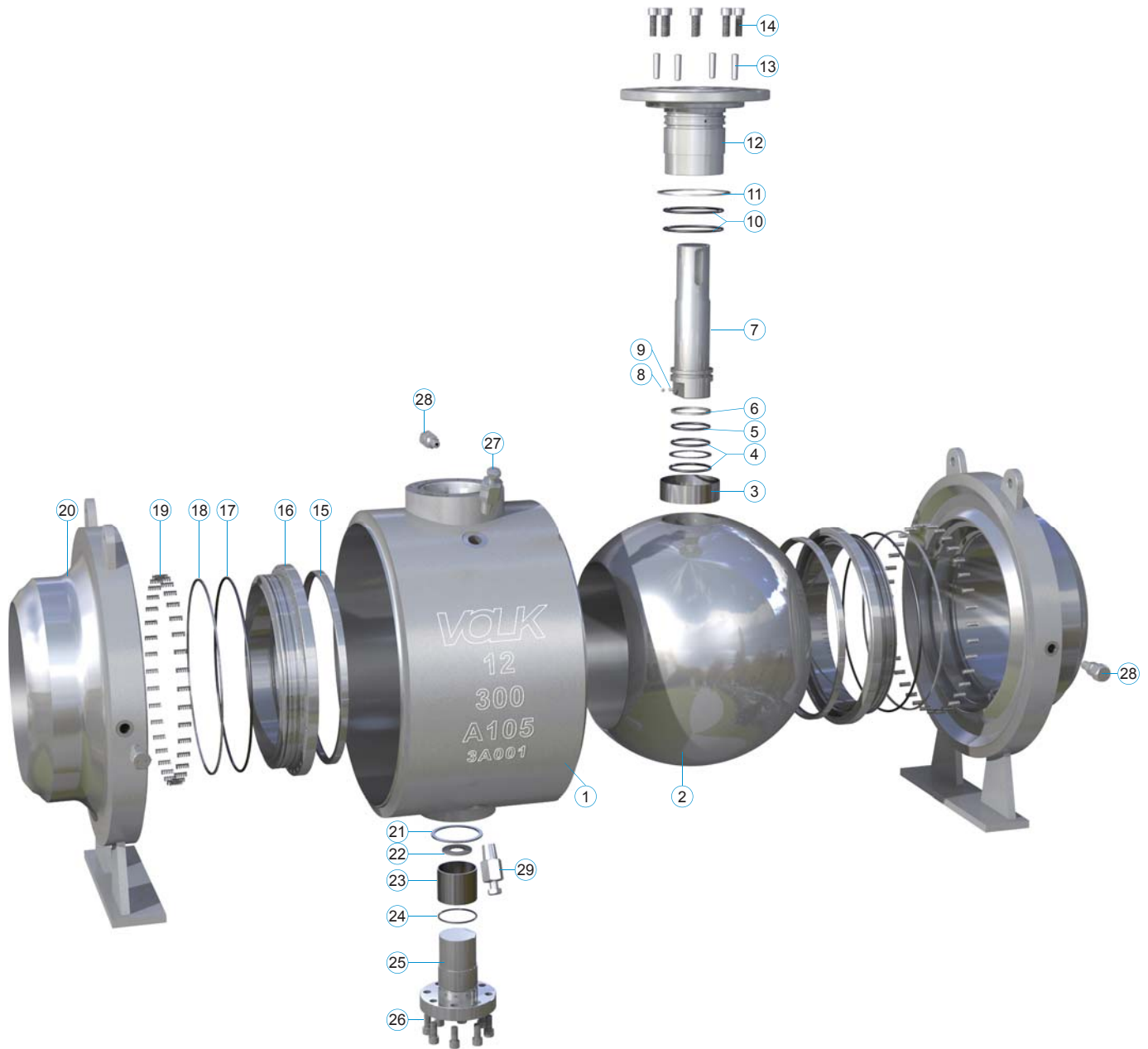

Item	Part Name
1	Body
2	Ball
3	Stem Bushing
4	Stem O-ring
5	Stem Gasket
6	Stem Retainer
7	Stem
8	Anti-static Ball
9	Anti-static Spring
10	O-ring

Item	Part Name
11	Spiral Gasket
12	Upper Cover
13	Pin
14	Cap Screw
15	Seat Insert
16	Seat Ring
17	Seat O-ring
18	Seat Retainer
19	Spring
20	End Connection

Item	Part Name
21	Spiral Gasket
22	Adjusting Gasket
23	Trunnion Bushing
24	O-ring
25	Trunnion
26	Cap Screw
27	Relief Valve
28	Grease Fitting Valve
29	Drain Plug

Fully-welded Body Ball Valve

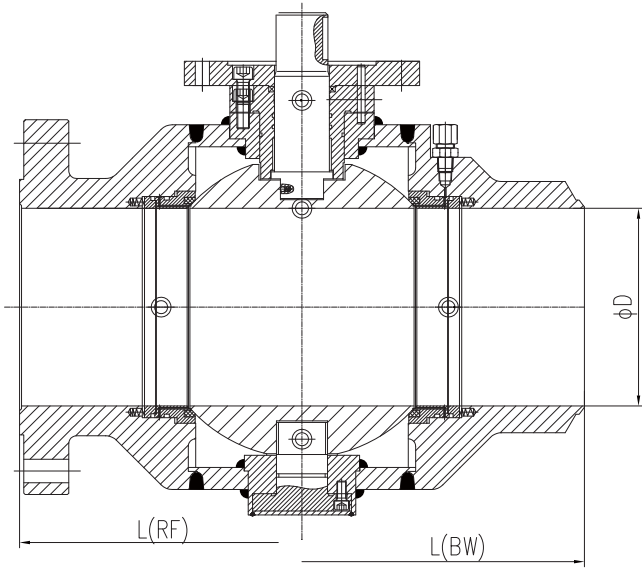

NPS 2 to NPS 12

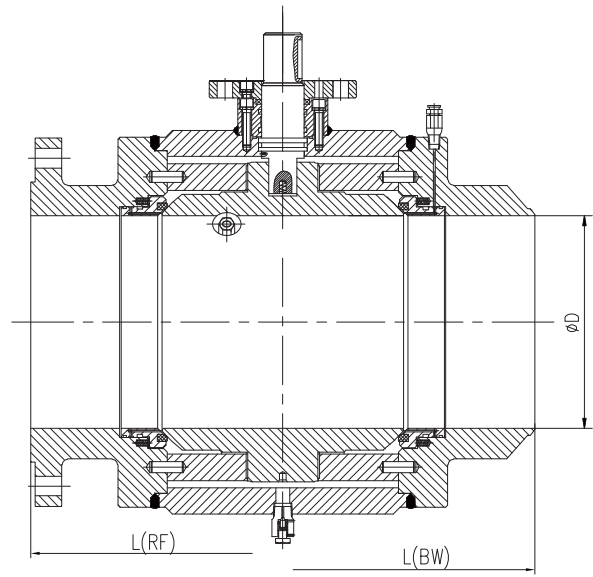

NPS 14 to NPS 60

Material List for Main Parts

Part Name	A105	A350 LF2	A182 F316
Body	A105	A350 LF2	A182 F316
Ball	A105+ENP	A350 LF2+ENP	A182 F316 / 17-4PH+ENP
Stem O-ring	VITON/Nylon		
Stem	A182 F316+ENP	4140+ENP	A182 F316 / 17-4PH+ENP
Upper Cover	1025	A350 LF2/A182 F6a	A182 F316
Seat Insert	PTFE/RPTFE/Nylon	PTFE/RPTFE/Nylon	PTFE/RPTFE/Nylon
Seat Ring	A105+ENP	A350 LF2+ENP	A182 F316+ENP
Spring	Inconel X-750		
End Connection	A105	A350 LF2	A182 F316
Trunnion	4140+ENP	A350 LF2+ENP	A182 F316+ENP
Relief Valve	CS+Zn	SS	SS
Grease Fitting Valve	CS+Zn	SS	SS
Drain Plug	CS+Zn	SS	SS

Optional trim materials are available upon request.

Dimensions (Imperial Units)

ANSI CLASS 150 - 600

SIZE	L (in)						D (in)			Weight (lb)					
	150		300		600		150	300	600	150		300		600	
	RF	BW	RF	BW	RF	BW	RF/BW	RF/BW	RF/BW	RF	BW	RF	BW	RF	BW
2	7.00	8.50	8.50	8.50	11.50	11.50	1.94	1.94	1.94	53.00	42.00	53.00	42.00	57.00	42.00
3	8.00	11.13	11.13	11.13	14.00	14.00	2.94	2.94	2.94	95.00	64.00	106.00	64.00	112.00	59.50
4	9.00	12.00	12.00	12.00	17.00	17.00	3.94	3.94	3.94	141.00	97.00	176.00	132.00	216.00	157.00
6	15.50	18.00	15.88	18.00	22.00	22.00	5.94	5.94	5.94	307.00	251.00	337.00	265.00	441.00	318.00
8	18.00	20.50	19.75	20.50	26.00	26.00	7.94	7.94	7.94	478.00	423.00	533.00	428.00	861.00	679.00
10	21.00	22.00	22.38	22.00	31.00	31.00	9.94	9.94	9.94	716.00	642.00	884.00	725.00	1279.00	970.00
12	24.00	25.00	25.50	25.00	33.00	33.00	11.94	11.94	11.94	972.00	862.00	1281.00	1061.00	1773.00	1420.00
14	27.00	30.00	30.00	30.00	35.00	35.00	13.19	13.19	13.19	1711.00	1568.00	1909.00	1623.00	2584.00	2238.00
16	30.00	33.00	33.00	33.00	39.00	39.00	15.19	15.19	15.19	2613.00	2238.00	3093.00	2542.00	3968.00	3351.00
18	34.00	36.00	36.00	36.00	43.00	43.00	17.19	17.19	17.19	3556.00	3071.00	4555.00	3849.00	5276.00	4636.00
20	36.00	39.00	39.00	39.00	47.00	47.00	19.19	19.19	19.19	4299.00	4136.00	4787.00	4412.00	7500.00	6587.00
22	39.00	43.00	43.00	43.00	51.00	51.00	21.19	21.19	21.19	5258.00	4817.00	5556.00	4982.00	8100.00	7020.00
24	42.00	45.00	45.00	45.00	55.00	55.00	23.19	23.19	23.19	6945.00	6702.00	7745.00	7304.00	10946.00	9751.00

ANSI CLASS 900 - 2500

SIZE	L (in)						D (in)			Weight (lb)					
	900		1500		2500		900	1500	2500	900		1500		2500	
	RF	BW	RF	BW	RF	BW	RF/BW	RF/BW	RF/BW	RF	BW	RF	BW	RF	BW
2	14.50	14.50	14.50	14.50	17.75	17.75	1.94	1.94	1.69	123.00	90.00	159.00	115.00	212.00	145.00
3	15.00	15.00	18.50	18.50	22.75	22.75	2.94	2.94	2.44	159.00	126.00	212.00	167.00	353.00	242.00
4	18.00	18.00	21.50	21.50	26.50	26.50	3.94	3.94	3.44	243.00	198.00	287.00	243.00	688.00	512.00
6	24.00	24.00	-	-	36.00	36.00	5.94	5.69	5.19	560.00	439.00	-	-	1687.00	1466.00
8	29.00	29.00	32.75	32.75	40.25	40.25	7.94	7.56	7.06	1158.00	948.00	1541.00	1272.00	3523.00	3236.00
10	33.00	33.00	39.00	39.00	50.00	50.00	9.94	9.44	8.81	1819.00	1466.00	3142.00	2700.00	6217.00	5423.00
12	38.00	38.00	44.50	44.50	56.00	56.00	11.94	11.31	10.44	2895.00	2410.00	3774.00	3219.00	8417.00	7183.00
14	40.50	40.50	49.50	49.50	-	-	12.69	12.44	-	3803.00	3208.00	6512.00	5544.00	-	-
16	44.50	44.50	54.50	54.50	-	-	14.69	14.19	-	5787.00	4773.00	8984.00	7588.00	-	-
18	48.00	48.00	60.50	-	-	-	16.69	16.00	-	7815.00	6801.00	10005.00	-	-	-
20	52.00	52.00	65.50	-	-	-	18.56	17.88	-	9165.00	7798.00	17361.00	-	-	-
24	61.00	61.00	-	-	-	-	22.44	21.50	-	16113.00	14085.00	-	-	-	-

For valves with sizes 24" and larger, please contact VOLK Sales Representative for detailed dimensions.

Dimensions (SI Units)

ANSI CLASS 150 - 600

SIZE	L (mm)						D (mm)			Weight (kg)					
	150		300		600		150	300	600	150		300		600	
	RF	BW	RF	BW	RF	BW	RF/BW	RF/BW	RF/BW	RF	BW	RF	BW	RF	BW
50	178.00	216.00	216.00	216.00	292.00	292.00	49.00	49.00	49.00	24.00	19.00	24.00	19.00	25.86	19.00
80	203.00	283.00	283.00	283.00	356.00	356.00	74.00	74.00	74.00	43.09	29.03	48.00	29.00	50.80	27.00
100	229.00	305.00	305.00	305.00	432.00	432.00	100.00	100.00	100.00	64.00	44.00	79.83	59.87	98.00	71.20
150	394.00	457.00	403.00	457.00	559.00	559.00	150.00	150.00	150.00	139.25	113.85	152.86	120.20	200.00	144.24
200	457.00	521.00	502.00	521.00	660.00	660.00	201.00	201.00	201.00	216.82	191.87	241.77	194.14	390.55	308.00
250	533.00	559.00	568.00	559.00	787.00	787.00	252.00	252.00	252.00	324.78	291.21	401.00	328.86	580.15	440.00
300	610.00	635.00	648.00	635.00	838.00	838.00	303.00	303.00	303.00	440.90	391.00	581.00	481.27	804.23	644.11
350	686.00	762.00	762.00	762.00	889.00	889.00	334.00	334.00	334.00	776.10	711.24	866.00	736.20	1172.00	1015.15
400	762.00	838.00	838.00	838.00	991.00	991.00	385.00	385.00	385.00	1185.25	1015.15	1403.00	1153.00	1800.00	1520.00
450	864.00	914.00	914.00	914.00	1092.00	1092.00	436.00	436.00	436.00	1613.00	1393.00	2066.13	1745.89	2393.18	2102.88
500	914.00	991.00	991.00	991.00	1194.00	1194.00	487.00	487.00	487.00	1950.00	1876.00	2171.37	2001.27	3402.00	2987.84
550	991.00	1092.00	1092.00	1092.00	1295.00	1295.00	538.00	538.00	538.00	2385.00	2185.00	2520.20	2259.82	3674.14	3184.25
600	1067.00	1143.00	1143.00	1143.00	1397.00	1397.00	589.00	589.00	589.00	3150.23	3040.00	3513.11	3313.00	4965.00	4423.00

ANSI CLASS 900 - 2500

SIZE	L (mm)						D (mm)			Weight (kg)					
	900		1500		2500		900	1500	2500	900		1500		2500	
	RF	BW	RF	BW	RF	BW	RF/BW	RF/BW	RF/BW	RF	BW	RF	BW	RF	BW
50	368.00	368.00	368.00	368.00	451.00	451.00	49.00	49.00	42.00	55.80	40.82	72.12	52.16	96.16	65.77
80	381.00	381.00	470.00	470.00	578.00	578.00	74.00	74.00	62.00	72.12	57.15	96.16	75.75	160.12	109.77
100	457.00	457.00	546.00	546.00	673.00	673.00	100.00	100.00	87.00	110.22	89.81	130.18	110.22	312.00	232.25
150	610.00	610.00	-	-	914.00	914.00	150.00	144.00	131.00	254.00	199.13	-	-	765.22	665.00
200	737.00	737.00	832.00	832.00	1022.00	1022.00	201.00	192.00	179.00	525.27	430.00	699.00	577.00	1598.00	1467.84
250	838.00	838.00	991.00	991.00	1270.00	1270.00	252.00	239.00	223.00	825.00	665.00	1425.20	1224.70	2820.00	2459.86
300	965.00	965.00	1130.00	1130.00	1422.00	1422.00	303.00	287.00	265.00	1313.16	1093.17	1711.88	1460.13	3818.00	3258.20
350	1029.00	1029.00	1257.00	1257.00	-	-	322.00	315.00	-	1725.00	1455.14	2953.82	2514.74	-	-
400	1130.00	1130.00	1384.00	1384.00	-	-	373.00	360.00	-	2625.00	2165.00	4075.12	3441.89	-	-
450	1219.00	1219.00	1537.00	-	-	-	423.00	406.00	-	3544.86	3084.91	4538.24	-	-	-
500	1321.00	1321.00	1664.00	-	-	-	471.00	454.00	-	4157.22	3537.15	7874.90	-	-	-
600	1549.00	1549.00	-	-	-	-	570.00	546.00	-	7308.80	6389.00	-	-	-	-

For valves with sizes 24" and larger, please contact VOLK Sales Representative for detailed dimensions.

Bolted Body Ball Valve - Exploded View

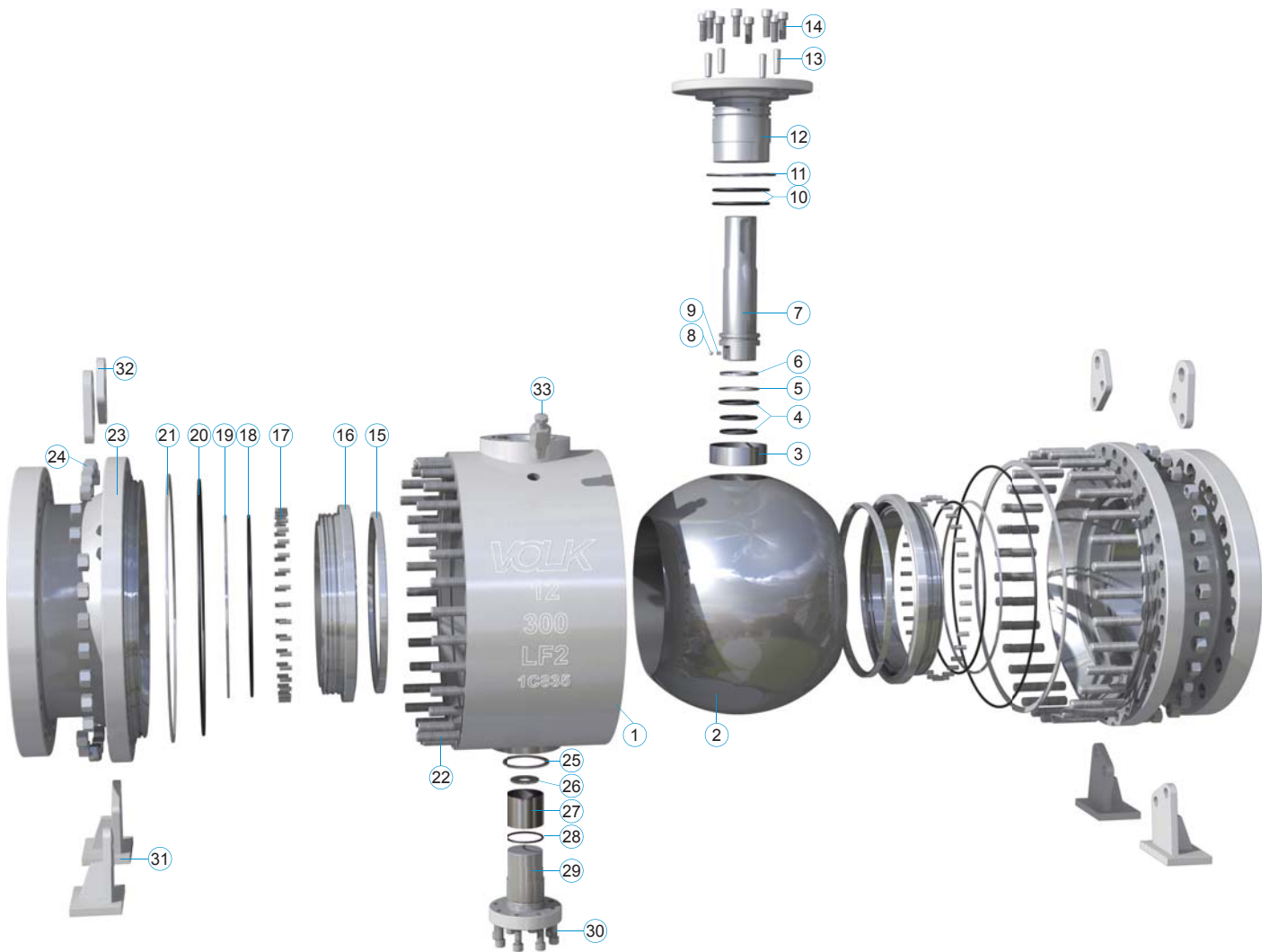

Item	Part Name
1	Body
2	Ball
3	Stem Bushing
4	Stem O-ring
5	Stem Gasket
6	Stem Retainer
7	Stem
8	Anti-static Ball
9	Anti-static Spring
10	O-ring
11	Spiral Gasket
12	Upper Cover
13	Pin
14	Cap Screw
15	Seat Insert

Item	Part Name
16	Seat Ring
17	Spring
18	Seat O-ring
19	Seat Retainer
20	End Connection O-ring
21	End Connection Gasket
22	Bolt
23	End Connection
24	Nut
25	Spiral Gasket
26	Adjusting Gasket
27	Trunnion Bushing
28	O-ring
29	Trunnion
30	Cap Screw

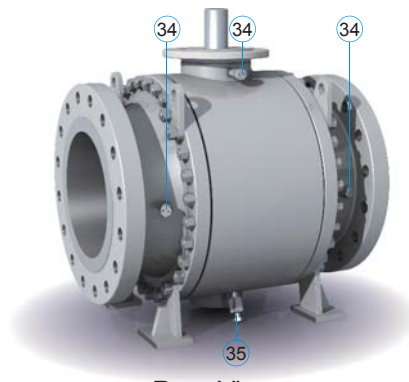

Rear View

Item	Part Name
31	Leg
32	Lug
33	Relief Valve
34	Grease Fitting Valve
35	Drain Plug

Bolted Body Ball Valve

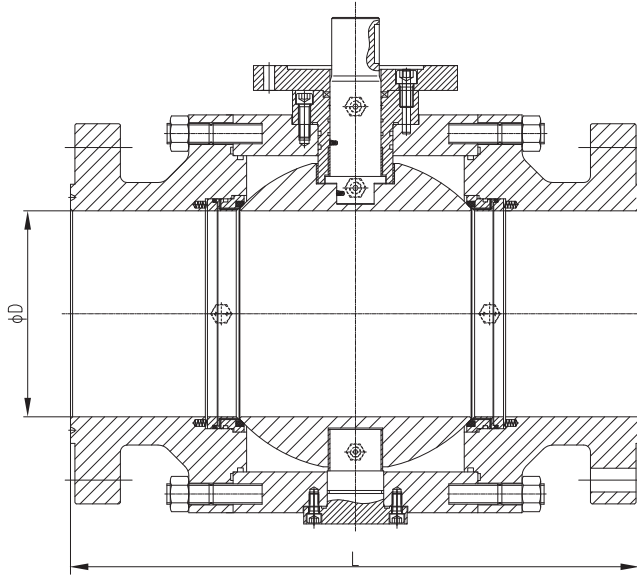

NPS 2 to NPS 12

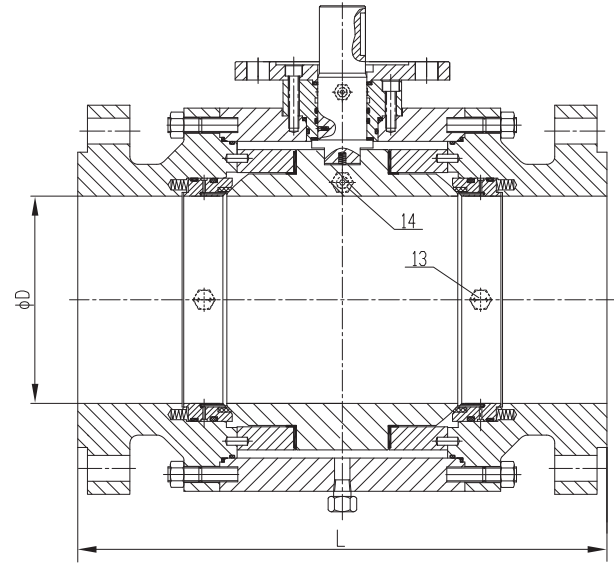

NPS 14 to NPS 60

Material List for Main Parts

Part Name	A105	A350 LF2	A182 F316
Body	A105	A350 LF2	A182 F316
Ball	A105+ENP	A350 LF2+ENP	A182 F316 / 17-4PH+ENP
Stem O-ring	VITON / Nylon		
Stem	A182 F316+ENP	4140+ENP	A182 F316 / 17-4PH+ENP
Upper Cover	1025	A350 LF2/A182 F6a	A182 F316
Seat Insert	PTFE/RPTFE/PEEK/Nylon	PTFE/RPTFE/PEEK/Nylon	PTFE/RPTFE/PEEK/Nylon
Seat Ring	A105+ENP	A350 LF2+ENP	A182 F316+ENP
Spring	Inconel X-750		
End Connection	A105	A350 LF2	A182 F316
Bolt	A193 B7	A193 B7	A193 B8
Nut	A194 2H	A194 7	A194 8
Trunnion	4140+ENP	A350 LF2+ENP	A182 F316+ENP
Relief Valve	CS+Zn	SS	SS
Grease Fitting Valve	CS+Zn	SS	SS
Drain Plug	CS+Zn	SS	SS

Optional trim materials are available upon request.

Dimensions (Imperial Units)

ANSI CLASS 150 - 600

SIZE	L (in)			D (in)			Weight (lb)		
	150	300	600	150	300	600	150	300	600
2	7.00	8.50	11.50	1.94	1.94	1.94	66.00	66.00	70.40
3	8.00	11.13	14.00	2.94	2.94	2.94	121.00	132.00	143.00
4	9.00	12.00	17.00	3.94	3.94	3.94	176.00	220.00	275.00
6	15.50	15.88	22.00	5.94	5.94	5.94	440.00	462.00	583.00
8	18.00	19.75	26.00	7.94	7.94	7.94	638.00	704.00	1144.00
10	21.00	22.38	31.00	9.94	9.94	9.94	990.00	990.00	1716.00
12	24.00	25.50	33.00	11.94	11.94	11.94	1298.00	1298.00	2464.00
14	27.00	30.00	35.00	13.19	13.19	13.19	1804.00	1804.00	3432.00
16	30.00	33.00	39.00	15.19	15.19	15.19	3476.00	4114.00	5280.00
18	34.00	36.00	43.00	17.19	17.19	17.19	5368.00	6050.00	7480.00
20	36.00	39.00	47.00	19.19	19.19	19.19	5720.00	6534.00	8646.00
24	42.00	45.00	55.00	23.19	23.19	23.19	9240.00	10318.00	14564.00

ANSI CLASS 900 - 2500

SIZE	L (in)			D (in)			Weight (lb)		
	900	1500	2500	900	1500	2500	900	1500	2500
2	14.50	14.50	17.75	1.94	1.94	1.69	110.00	121.00	132.00
3	15.00	18.50	22.75	2.94	2.94	2.44	176.00	220.00	273.00
4	18.00	21.50	26.50	3.94	3.94	3.44	308.00	363.00	430.00
6	24.00	27.75	36.00	5.94	5.69	5.19	858.00	1298.00	1663.00
8	29.00	32.75	40.25	7.94	7.56	7.06	1540.00	2046.00	2435.00
10	33.00	39.00	50.00	9.94	9.44	8.81	2420.00	4180.00	5627.00
12	38.00	44.50	56.00	11.94	11.31	10.44	3850.00	5016.00	6320.00
14	40.50	49.50	-	12.69	12.44	-	5060.00	8668.00	-
16	44.50	54.50	-	14.69	14.19	-	7700.00	11946.00	-
18	48.00	-	-	16.69	-	-	10406.00	-	-
20	52.00	-	-	18.56	-	-	12188.00	-	-
24	61.00	-	-	22.44	-	-	21450.00	-	-

For valves with sizes 24" and larger, please contact VOLK Sales Representative for detailed dimensions.

Dimensions (SI Units)

ANSI CLASS 150 - 600

SIZE	L (mm)			D (mm)			Weight (kg)		
	150	300	600	150	300	600	150	300	600
50	178.00	216.00	292.00	49.00	49.00	49.00	30.00	30.00	32.00
80	203.00	283.00	356.00	74.00	74.00	74.00	54.90	59.87	64.86
100	229.00	305.00	432.00	100.00	100.00	100.00	79.83	99.80	124.74
150	394.00	403.00	559.00	150.00	150.00	150.00	199.58	209.56	264.45
200	457.00	502.00	660.00	201.00	201.00	201.00	289.39	319.33	518.91
250	533.00	568.00	787.00	252.00	252.00	252.00	449.00	449.00	778.37
300	610.00	648.00	838.00	303.00	303.00	303.00	588.77	588.77	1117.66
350	686.00	762.00	889.00	334.00	334.00	334.00	818.30	818.30	1556.74
400	762.00	838.00	991.00	385.00	385.00	385.00	1576.70	1866.10	2395.00
450	864.00	914.00	1092.00	436.00	436.00	436.00	2434.91	2744.26	3392.91
500	914.00	991.00	1194.00	487.00	487.00	487.00	2594.57	2963.80	3921.80
600	1067.00	1143.00	1397.00	589.00	589.00	589.00	4191.24	4680.21	6606.20

ANSI CLASS 900 - 2500

SIZE	L (mm)			D (mm)			Weight (kg)		
	900	1500	2500	900	1500	2500	900	1500	2500
50	368.00	368.00	451.00	49.00	49.00	42.00	49.90	54.90	59.87
80	381.00	470.00	578.00	74.00	74.00	62.00	79.83	99.80	123.83
100	457.00	546.00	673.00	100.00	100.00	87.00	139.71	164.66	195.00
150	610.00	705.00	914.00	150.00	144.00	131.00	389.20	588.77	754.33
200	737.00	832.00	1022.00	201.00	192.00	179.00	698.54	928.00	1104.51
250	838.00	991.00	1270.00	252.00	239.00	223.00	1097.70	1896.00	2552.40
300	965.00	1130.00	1422.00	303.00	287.00	265.00	1746.35	2275.24	2866.73
350	1029.00	1257.00	-	322.00	315.00	-	2295.20	3931.78	-
400	1130.00	1384.00	-	373.00	360.00	-	3492.70	5418.67	-
450	1219.00	-	-	423.00	-	-	4720.13	-	-
500	1321.00	-	-	471.00	-	-	5528.44	-	-
600	1549.00	-	-	570.00	-	-	9729.66	-	-

For valves with sizes 24" and larger, please contact VOLK Sales Representative for detailed dimensions.

How to Order



A. VALVE TYPE

VW	Fully welded body ball valve
V3	Three piece body ball valve

B. OPERATOR MODE

L	LEVER	E	ELECTRIC
W	WORM GEARING	P	PNEUMATIC
Cy	CYLINDER GEAR-DRIVEN	H	HYDRAULIC
C	CONIC GEAR-DRIVEN	BS	BARE STEM

C. ANSI CLASS CODE

1	Class 150	7	Class 900
3	Class 300	9	Class 1500
6	Class 600	0	Class 2500

D. PORT CODE

FP	Full Port
RP	Reduced Port
XX	Others

E. BODY MATERIAL CODE

01	A105	08	A182 F316L
02	A182 F11	09	A350 LF2
03	A182 F22	10	A350 LF5
04	A182 F91	11	A350 LF9
05	A182 F304	12	A350 LF3
06	A182 F316	13	A182 F51
07	A182 F304L		

F. SEAT MATERIAL CODE

For Soft Seats

T	PTFE
P	PEEK
R	RPTFE
L	Nylon

For Metal Seats

H	Chrome Carbide Coated
W	Tungsten Carbide Coated
S	Overlay Stellite
M	Overlay Martensite Stainless Steel
U	Overlay Austenite Stainless Steel
C	Hard Chrome Plating
X	Oxidizing

G. END CONNECTION CODE

BW	BUTT WELD
SW	SOCKET WELD
RF	RAISED FACE
RJ	RING JOINT
TH	THREAD

H. SIZE CODE

Size	2"	4"	6"	60"
Code	2	4	6	60

Torque Information

Please contact VOLK Sales Representative for detailed torque information for power actuator sizing.

VOLK Service Center (Houston, Texas)

All VOLK Flow Controls products are serviced by our full service valve maintenance facility right here in Houston, Texas with a complete scope of work that includes valve modifications (trim, end connection, cryogenic extension), testing and remanufacturing. In addition to MRO (maintenance, repair, and overhaul) services and inventory modifications for our customers, our maintenance facility serves as a complete warranty and modification center for all VOLK Flow Controls products.





Corporate Headquarters
6820 Easthaven Blvd, Houston, TX 77017
Tel: +1-713-947-2606
Fax: +1-713-947-2673
[Http://www.volkvalves.com](http://www.volkvalves.com)
E-mail: sales@volkvalves.com